

Original Research Article

<https://doi.org/10.20546/ijcmas.2020.906.094>

Development of Solar operated Maize Sheller

Bhupendra Ghritalahre* and M. Quasim

FMPE, SVCAET&RS, IGKV, Raipur (C.G.), India

*Corresponding author

ABSTRACT

Keywords

Development,
Shelling, Solar
Energy, Maize

Article Info

Accepted:
15 May 2020
Available Online:
10 June 2020

Maize sheller is the most common shelling machine or device for maize. In the market there is numbers of maize sheller either manually operated or power operated is available but research has been going on to design a simple and productive maize sheller. The developed solar maize sheller is solar powered to suit the maize farmers of remote area where electricity is not available. The sheller consist different component such as Shelling assembly, DC motor, Solar panel, Battery etc. the overall dimension of developed solar maize sheller is 1055 mm X 645 mm X 450 mm. the solar panel of capacity 40 watt is use as source of energy for dc motor of 250 watt. In additional battery of capacity 168 watt is provided. The output capacity of the developed sheller is 174.33 kg/h.

Introduction

Maize (*Zea mays* L) is one of the most versatile emerging crops having wider adaptability under varied agro-climatic conditions. Maize is the fast-growing crop in India and second preferred crop after paddy in some state. The processing of maize includes three major steps namely harvesting, shelling and milling in which all the step have their own importance. Harvesting is the plucking of cob from the plant and then the plant is harvested for animal feeding. After plucking the maize cob from the plant, maize cob is

dehusked manually and then dried by using sun rays to reduce the moisture content. Shelling is the process of removing maize kernel from cobs. There are different types of shelling equipment and each type has different scales of conditions and production. Maize shelling manually is a very exhausting and time-consuming task and the palm and fingers of farm women injured during maize shelling which decreases the efficiency of farm women. The power maize shelling need high capital investment and cannot use in remote areas. So it is need to develop a sheller for marginal farmer of remote area which

overcome the problem arising during maize shelling.

Materials and Methods

Working Principle of solar maize sheller

The machine is work on the principle of photovoltaic effect. The developed solar maize sheller use solar panel for energy. Solar energy is converted to DC current by the solar panel and transfer the current to the battery and motor. In the machine one on/off switch is provided to control the flow of current. Arrangement is in such a way that solar panel and battery can simultaneously use for operating machine and also individually. In non-working time solar panel charge the battery used. In shelling cylinder the iron chain with iron bar at the end is provided which rotate with rotating shaft. The rotating motion of shaft is received from DC motor and continuously strike the maize cob. The maize kernel is perfectly dried and start detaching from cobs.

Design consideration

The design of machine include the calculation of power required, length of chain and calculation of speed ratio etc. the main component of machine is chain and sprocket for drive mechanism and electrical arrangement to suit the working condition. Sieve of suitable opening is use to remove the maize kernel through it.

Performance of the developed machine is evaluated using the different maize variety of maize crop and also for different rate of feeding. The performance of sheller is evaluated on the use of mathematical formula (BIS standard). The result obtain from evaluation show that the capacity of sheller is 174.33 kg/h with shelling cost 0.266 Rs/kg. By analysing the result developed machine is found satisfactory.

Constructional detail of component and material used

The developed maize sheller consists following main parts:

Machine frame

The machine frame is rigid base of the machine. Frame carries an entire load of shelling assembly. The frame supports the entire component and gives strength to the machine while working. The M.S. angular bar of size 40 X40 mm and having a thickness of 5 mm was used for manufacturing. The bottom side of the frame is also rigidly fixed with the angular bar to give extra support to the frame. The machine frame is fabricated with overall dimension 645 mm length, 765 mm height and 450 mm width.

Shelling assembly

The shelling assembly consist shelling cylinder (inner cylinder), sieve attached to the bottom of the cylinder and outer cover. The shelling cylinder is made up of an MS sheet having thickness 7mm.the shaft is attached with the help of coupler and coupler is fixed in the frame. The shaft inside the cylinder is provided with the iron chain and welded at a specific distance. The length of the iron chain was 160 mm and the distance between two chains was 90 mm. The length of the threshing cylinder is 490 mm and the diameter is 390 mm. the sieve is placed at a distance 350 mm from the top of the cylinder and 40 mm from the bottom of the cylinder.

Shaft

The shaft is a solid rod of mild steel material. The shaft bear the force and torque generated. The shaft is equipped with an iron chain and at the end of the chain, small solid bar is welded. The length of the shaft is 750 mm and the diameter of the shaft is 21mm.

Sieve

Sieve is a perforated GI sheet. The perforation on the sieve is 10mm. The sieve is attached to the bottom of the shelling assembly to allow the falling of shelled maize kernel and retain the cob pith. The sieve is fitted at a distance of 40 mm from the bottom of the cylinder. The sieve dimension is 470 mm x 210 mm.

D. C. motor

The motor is fixed at a distance of 340 mm from the top of the frame and 355 mm from the bottom of the frame. Power is transmitted to shaft by using the chain and sprocket. The actual speed of the motor is 3000 rpm which is reduced to 300 rpm by gear arrangement by the manufacturer. The diameter of the shaft is 8 mm. the power required to shell the maize is found 130 watt and is calculated using following formula

Total power required to shell the maize (Kumar *et al.*, 2016)

$$P_T = P_{ironchain} + P_{Shaft} + P_{shelling} \quad (1)$$

$P_{ironchain}$ = Power in inner iron chain
 P_{shaft} = Power in shaft
 $P_{shelling}$ = Power utilized by shelling (seed)

Chain and sprocket

Chain and sprocket are used for power transmission. Two sprockets are used, one is attached with the motor shaft and another is machine shaft. The power from the motor shaft and sprocket is delivered to the sprocket and shaft of the machine through the chain. In driver sprocket, there are 21 teeth having pitch circle diameter 12.7 mm and 17 teeth for driven sprocket having pitch circle 12.7 mm. The speed ratio of diver and driven sprocket is 2.13. The length of the chain is 960 mm

and the number of the link on the chain is 72. The above parameters are calculated using following formula.

The size of the sprocket is measured on the basis of teeth and the revaluation of the sprocket. (Sharma 2013)

$$RPM_1 \times N_1 = RPM_2 \times N_2 \quad (2)$$

Where,
 RPM_1 = No. of revolution of driver sprocket
 RPM_2 = No. of revolution of the driven sprocket
 N_1 = Number of teeth on driver sprocket
 N_2 = Number of teeth on driven sprocket

Chain Length can be determined by using the following formula according to Khurmi *et al.*, (2005).

$$L = \frac{p}{2} (T_1 + T_2) + 2x + \frac{\left\{ \frac{p}{2} \operatorname{cosec} \left(\frac{180^\circ}{T_1} \right) - \frac{p}{2} \operatorname{cosec} \left(\frac{180^\circ}{T_2} \right) \right\}^2}{x} \quad (3)$$

Where,
 p =pitch of chain
 T_2 = No. of teeth in driven sprocket
 T_1 = No. of teeth in driver sprocket
 x = distance between the shaft

Battery

The battery is shown in fig 3.22. The battery is a device used to convert the chemical energy into electrical energy.it is used to run the motor. The dry battery of 12 volts and 7ah is used.

Solar panel

A solar panel is a device that is the best source of direct current. The solar panel is an arrangement of the solar cell. The solar cell is

made up of silicon and work based on photovoltaic effect it produces energy with the help of sunlight.it uses photons of sunlight

to convert it into energy. The solar panel used is 12 volt. 2 unit of 40 watts solar panel are used.

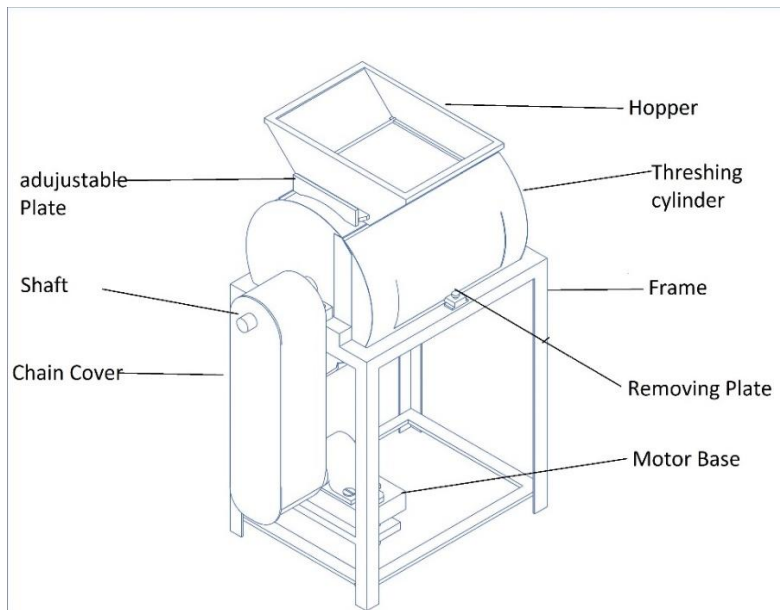

Fig.1 Component of sheller

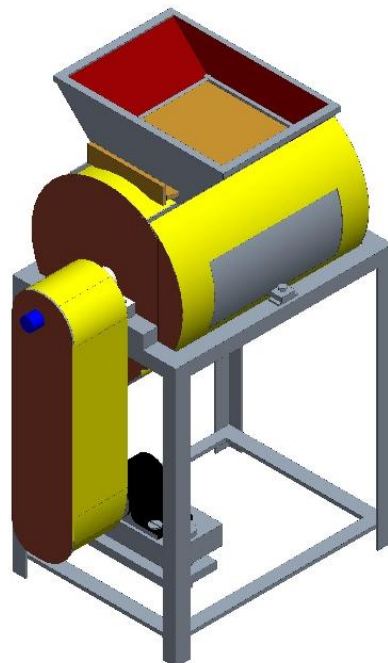

Fig.2 3D view of sheller

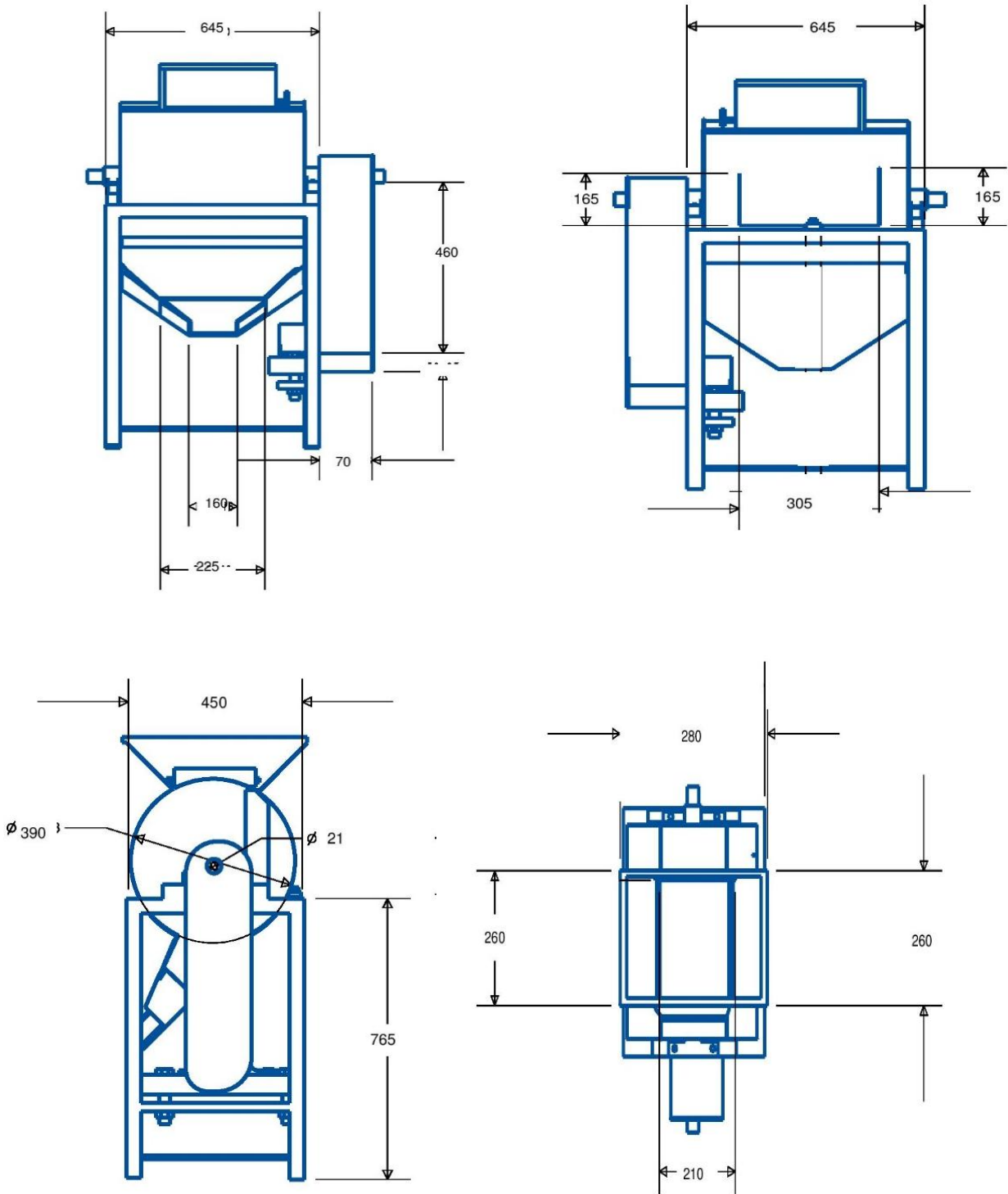

Fig.3 Schematic diagram of machine

References

Amare, D., Endelaw, W., Yayu, N., Endeblihatu, A., Biweta, W., Tefera, A. and Tekeste, S. 2017. Evaluation and

demonstration of maize shellers for small-scale farmers. MOJ Applied Bionics and Biomechanics, 1(3):93-98.
 Anonymous 1986. Small-scale maize milling, UNIDO/ILO Technical Memorandum

- No.6, January p.51, 53.
CIAE, Bhopal. 2005. Drudgery reducing technologies for women in agriculture. [http:// www.ciae.nic.in](http://www.ciae.nic.in).
- Joshi Hem Chandra, 1981. Design and selection of thresher parameters and components. *Agril. Mechanization in Asia, Africa, Latin America*,12(2): 61-70.
- Khurmi, R.S. and Gupta, J.K. 2005. A textbook of machine design.14th edition, S. Chand and Co. Ltd. New Delhi, p.375-376.
- Sahu, D. K., Sahu, O., Sahu, P. K., Gour, R and Sahu, Y. K. 2016. Design, development and testing of groundnut decorticator. B. Tech Thesis, Indira Gandhi Krishi Vishwavidyala, Raipur, p. 30.
- Sharma, D. N. and Mukesh, S. 2013. Farm machinery design principles and problems. 3rd Edition, Jain brothers New Delhi- 110005: 56-57.
- CIAE, Bhopal. 2005. Drudgery reducing technologies for women in agriculture. [http:// www.ciae.nic.in](http://www.ciae.nic.in).

How to cite this article:

Bhupendra Ghritalahre and Quasim, M. 2020. Development of Solar operated Maize Sheller. *Int.J.Curr.Microbiol.App.Sci*. 9(06): 738-743. doi: <https://doi.org/10.20546/ijcmas.2020.906.094>